



Tip-Seal® Air Operated Fluid Dispense Valve



- ▶ **Fluid control valve for use with low to high viscosity materials**
- ▶ **Tip-Seal design for instantaneous shut-off of material flow, at the tip, with a zero cavity**
- ▶ **Divorced design air and material sections**
- ▶ **Double air operated: air to open and air to close**
- ▶ **Hardened needle and seat**
- ▶ **Standard elastoplastic seals resist the effects of wear; numerous seal alternatives available for material compatibility**
- ▶ **Aluminum and steel wetted components**
- ▶ **Includes drill thru and/or dowel pin locator holes for mounting or fixturing**

2200-1051-000-AA

The **2200-1051-Series** is an automatic air operated *Tip-Seal*® dispense valve for applying all viscosities of single component adhesives, sealants and lubricants. Because of the seal design, it is ideally suited to handling abrasive or filled materials.

The valve's unique *Tip-Seal* action insures a quick, positive stop of material flow when the valve is closed, with no material exposed to atmosphere. The quick stoppage of material flow is especially good for applications requiring no stringing between applied drops or beads.

The valve features a divorced air and material design, air to open/close, hardened needle and seat, and 1/4" N.P.T.F. material inlet port.

The valve includes a 25/64" diameter through hole for fixturing or dowel pin locator holes for repeatable robot mounting. A fixture rod may be secured in position using the 1/4-20 threaded hole intersecting with the through hole.

A 4-way pneumatic valve, (not included except manual valves), is required to operate the valve.

45677 Helm Street • P.O. Box 701460 • Plymouth, MI 48170 • USA

Phone: (734) 459-8600 • Fax: (734) 459-8686

E-mail: dispensevalves@sealantequipment.com • Web: www.dispensevalves.com



2200-1051-Series Tip-Seal® Dispense Valve

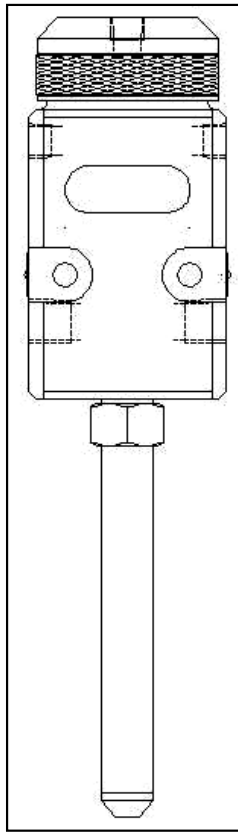

2200-1051-001-AA

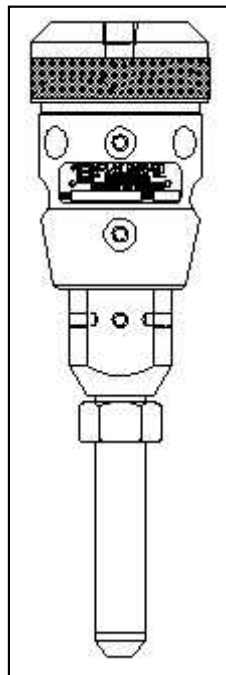

2200-1051-002-AA

SPECIFICATIONS:

- Weight (Dry):** Approx. 2.75 lbs; 1.25 kg.
- Max Working Pressure:** 4,000 P.S.I. (276 Bar)
- Material Inlet:** 1/4" N.P.T. (F)
- Air Ports:** (2) 1/8" N.P.T. (F) (Open/Close)
- Air Pressure Required:** 60 P.S.I. (4.0 Bar) Min.
- Packings:** Elastoplastic
- Actuator:** 4-Way Pneumatic Valve (not included)
- Service Kit:** 2150-145-010 (for 2200-1051-001-AA)
2150-459-010 (for 2200-1051-001-AA)
2150-448-000 (for 2200-1051-000-AA)

Options:

- Variety of O-ring & Seal Compounds

Nozzle Length & Orifice:

| <u>Model</u> | <u>Nozzle Length</u> | <u>Orifice</u> |
|------------------|----------------------|------------------|
| 2200-1051-000-AA | 4.5" (114.3mm) | 0.13" (3.30 mm) |
| 2200-1051-001-AA | 4.5" (114.3mm) | 0.125" (3.18 mm) |
| 2200-1051-002-AA | 2.64" (67 mm) | 0.13" (3.30 mm) |



Form 1051-1004 • Copyright 2004



Manufacturers of Precision Dispense Systems & Valves

45677 Helm Street • P.O. Box 701460

Plymouth, MI 48170 • USA

Phone: (734) 459-8600

Fax: (734) 459-8686

Web: www.dispensevalves.com

E-mail: dispensevalves@sealantequipment.com